



Corporation of the Township of Essa
5786 Simcoe County Road #21
Utopia, Essa Township, Ontario
LOM 1T0

**NOTICE OF A PUBLIC HEARING FOR A CONSENT APPLICATION(S) NO. B3/24,
B4/24, and B5/24**

TAKE NOTICE that an application has been submitted for three (3) Consent applications on the lands known legally as PLAN 160A LOT 2 TO 4 & PLAN 160A LOT 5, municipally known 14 & 18 Margaret Street. The subject properties are designated 'Residential', and 'Institutional'. The applicant has applied for three (3) Consent applications; one (1) for a Lot Line Adjustment, and two (2) the creation of two new lots on the lands known as 18 Margaret Street. The applicant intends to transfer 960.6m² from 18 Margaret Street to 14 Margaret Street. The applicant then intends to sever a new lot off 14 Margaret Street (containing the Zion Presbyterian Church) that would have a total lot area of 688.30m². Following the lot line adjustment, the applicant also intends to split 18 Margaret Street into two parcels: the retained lot would have a lot area of 353.50m², and the severed lot would have a lot area of 355.06m².

AND FURTHER TAKE NOTICE that the Committee of Adjustment has appointed June 28th, 2024, for a Public Hearing to be held at approximately 10:00 a.m.

You may make a written submission through the undersigned Secretary-Treasurer in which your comments will be provided to the Committee of Adjustment prior to their decision on the application. If you wish to be notified of the decision of the Committee of Adjustment in respect of this application, you must make a written request to the Committee of Adjustment at the address shown above, or via email to ocurnew@essatownship.on.ca.

DATED this 7th day of June 2024.

Yours truly,

A handwritten signature in black ink, appearing to read 'Owen Curnew', with a long horizontal flourish extending to the right.

Owen Curnew
Development Planner
ocurnew@essatownship.on.ca
(705) 424-9917 ext.104

Proposal:

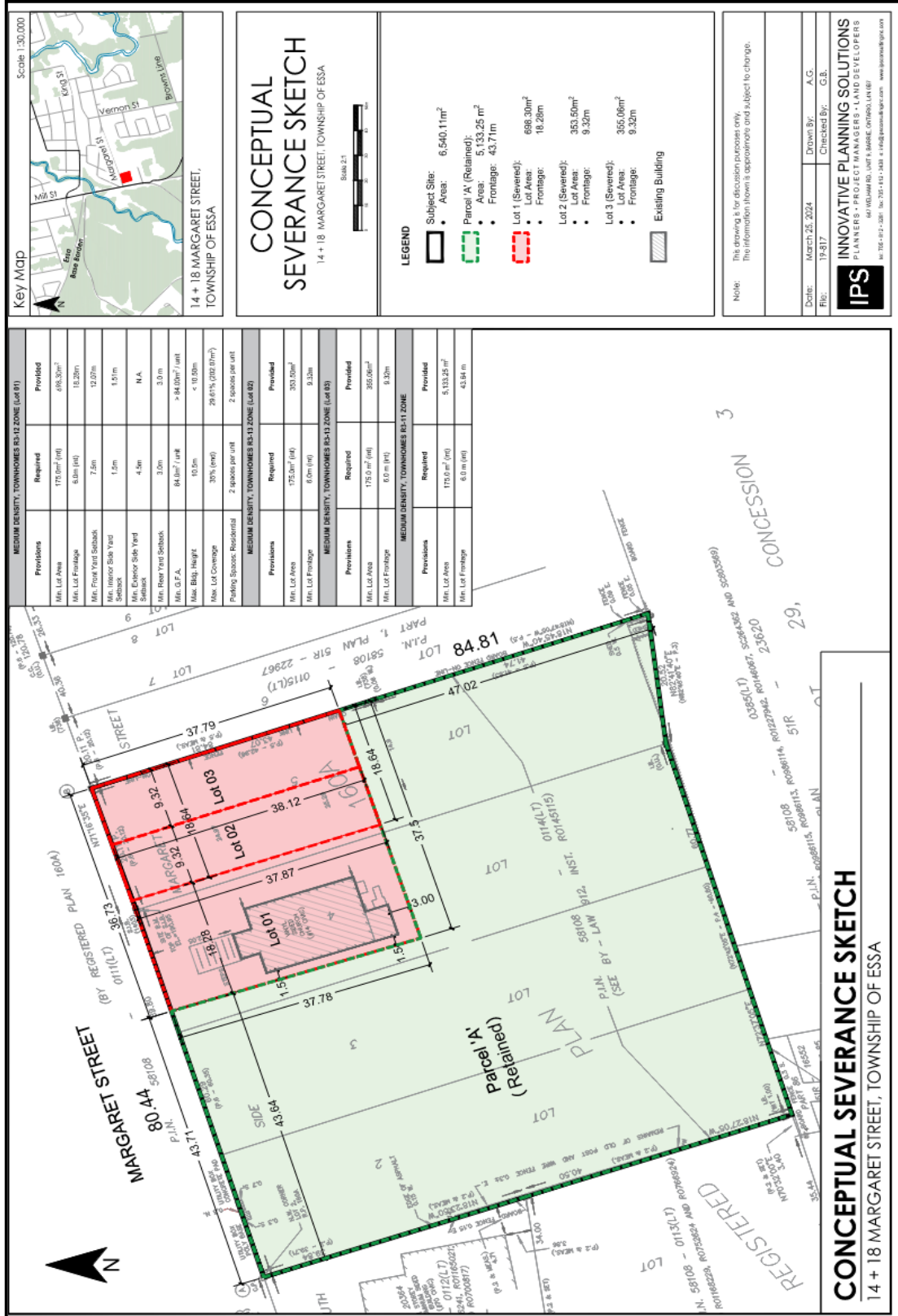

Note: This drawing is for discussion purposes only. The information herein is approximate and subject to change.

Date: March 25, 2024
Drawn By: A.G.
File: 19-817
Checked By: G.B.

IPS
INNOVATIVE PLANNING SOLUTIONS
PLANNERS - PROJECT MANAGERS - LAND DEVELOPERS
641 WILKINSON AVENUE, SUITE 100, WILKINSON, ONTARIO, CANADA
Tel: 705-912-1261 Fax: 705-912-1248 Email: ips@innovative-ips.com www.ipsinnovative.com